

MODEL YK17

FULL PORT
 1000 WOG
 1/4"-4"

MATERIALS LIST

NO.	PART NAME	SPECIFICATION	Q'TY
1	BODY	ASTM A351 CF8M	1
2	END CAPS	ASTM A351 CF8M	2
3	BALL	ASTM A351 CF8M	1
4	STEM	S.S.316	1
5	BALL SEATS	PTFE	2
6	END SEALS	PTFE	2
7	STEM PACKING	PTFE+15%GF	2
8	O-RING	VITON	1
9	DISC SPRING	SUS304CSP	2
10	RETAINING RING	S.S.304	1
11	BOLTS	S.S.304	4-6
12	BOLT NUTS	S.S.304	4-6
13	BOLT WASHERS	S.S.304	4-6

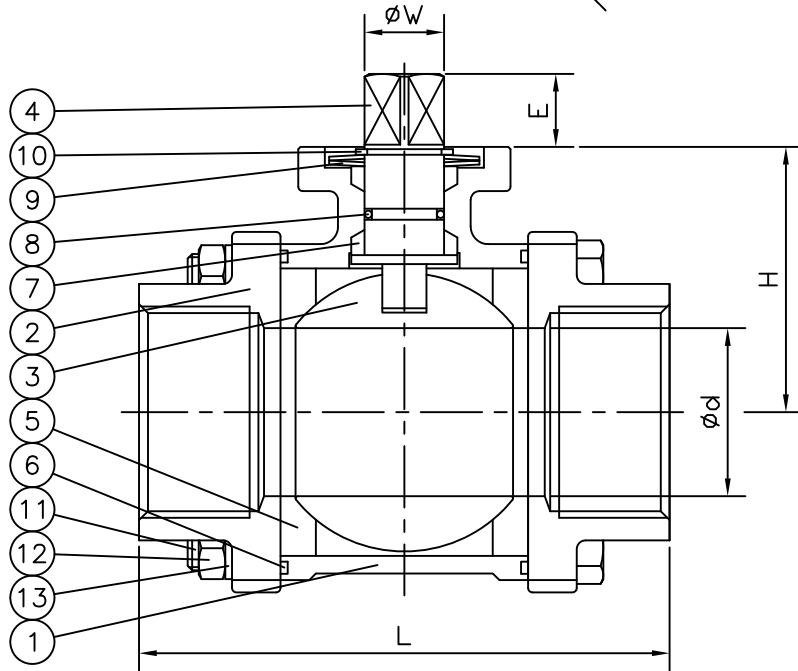

DIMENSIONS

TYPE SIZE	Ød	L	H	D	E	W	ISO 5211	
							P	ØQ
1/4"	0.44	2.36	1.44	0.35	0.35	0.47	1.42/1.65	0.24
3/8"	0.5	2.36	1.44	0.35	0.35	0.47	1.42/1.65	0.24
1/2"	0.63	2.95	1.44	0.35	0.35	0.47	1.42/1.65	0.24
3/4"	0.79	3.15	1.56	0.35	0.35	0.47	1.42/1.65	0.24
1"	0.98	3.54	1.87	0.43	0.43	0.55	1.65/1.97	0.24/0.28
1-1/4"	1.26	4.33	2.09	0.43	0.43	0.55	1.65/1.97	0.24/0.28
1-1/2"	1.50	4.72	2.42	0.55	0.55	0.71	1.97	0.28
2"	2.0	5.51	2.78	0.55	0.55	0.71	1.97	0.28
2-1/2"	2.5	6.81	3.78	0.67	0.73	0.87	2.76	0.35
3"	3.0	7.32	4.17	0.67	0.73	0.87	2.76	0.35
4"	3.94	8.86	5.31	0.87	0.97	1.10	4.02	0.43

3PC BALL VALVE 1000WOG WITH DIRECT ISO5211 MOUNTING PAD

DATE 2015/8/18

NO	DATE	DESCRIPTION	CONFIRM	DIM.	0.5	3	6	30	120	315	MATERIAL	CF8M	DRAWN
4				CLASS	3	6	30	120	315	1000	TREATMENT		CHECK
3				CLASS 1	0.05	0.05	0.1	0.15	0.2	0.3	WEIGHT(Kg)		APPROVED
2				CLASS 2	0.1	0.1	0.2	0.3	0.5	0.8	SCALE		
1				CLASS 3	0.15	0.2	0.5	0.8	1.2	2	DRAWING NO.	YK17	J & M INTERNATIONAL LTD.