

# Fig.NO. #5314 Three Piece Swing-out In-line Maintenance

## 1000PSI STAINLESS STEEL BALL VALVES - FULL PORT, W/ ISO 5211 MOUNTING PAD

### FEATURE & SPECIFICATIONS

- \* Direct-mounting of actuators to valves
- \* For food and general chemical service applications
- \* Adjustable stem pack
- \* Blow-out proof stem design
- \* Body and end caps quality investment casting
- \* In-line repairable
- \* Available in carbon or stainless steel body construction
- \* 100% tested air under water, at 100psi, open and closed positions
- \* Anti-static design is standard

### SPECIFICATIONS

- \* Working pressure: 1/2"~2" 1000psi W.O.G
- 2 1/2"~3" 800psi W.O.G
- 4" 600psi W.O.G

- \* Temperature Range: -20 to 450°F

- \* End Type: threaded

### OPTIONS

- \* Padlocking device
- \* Actuator mounting bracket

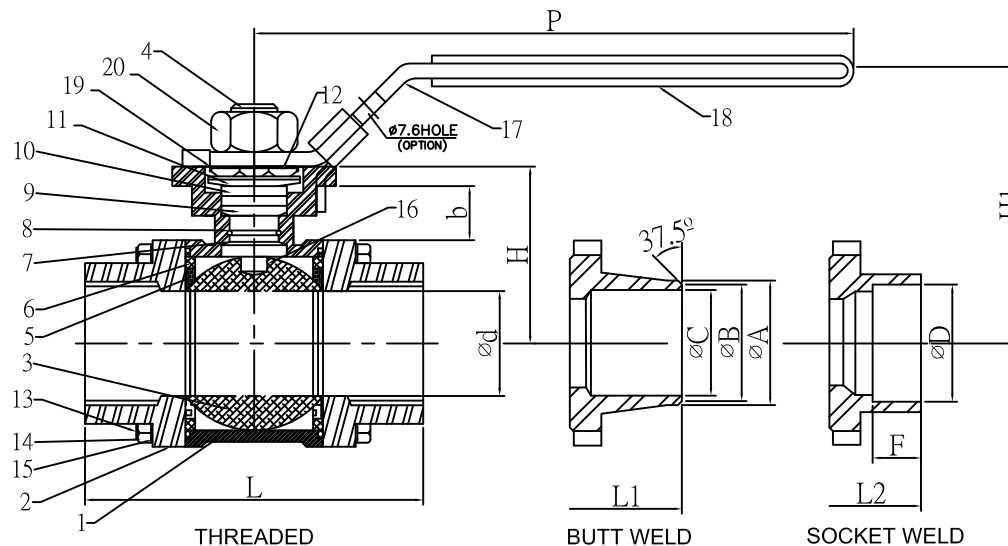
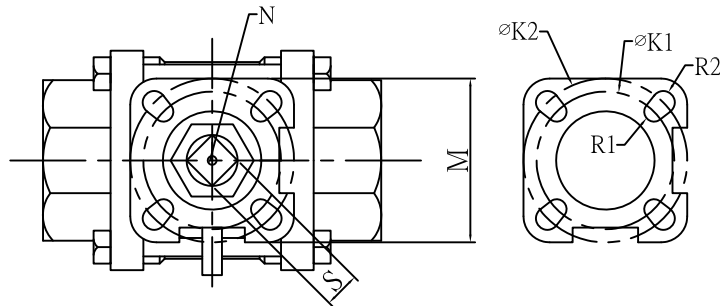

### J&M INTERNATIONAL LTD.

NO.	PART NAME	MATERIAL
		STAINLESS STEEL / CARBON STEEL
1	BODY	ASTM A351 GR. CF8M / A216WCB
2	CAP	ASTM A351 GR. CF8M / A216WCB
3	BALL	ASTM A351 GR. CF8M / CF8
4	STEM	ASTM A276 TYPE 316
5	SEAT	PTFE
6	GASKET	PTFE
7	THRUST WASHER	POLYFILL TEFLON
8	O-RING	VITON
9	STEM PACKING	PTFE
10	GLAND RING	SS304
11	BEVEL WASHER	SS301
12	STEM NUTS	SS304
13	BOLTS	SS304
14	BOLT NUTS	SS304
15	BOLT WASHERS	SS304
16	STATIC DEVICE	SS304
17	HANDLE	SS304
18	HANDLE SLEEVE	VINYL GRIP
19	LOCK CAP	SS304
20	HANDLE NUT	SS304

SIZE	Ød	L	H	H1	P	S	M	ØK1	ØK2	R1	R2	b	N	ØA	ØB	ØC	ØD	F	L1	L2	
DN15	1/2"	0.59	2.58	1.69	2.87	4.57	0.35	1.65	1.42	1.65	0.12	0.12	0.63	1/4-20UNC	0.91	0.75	0.62	0.87	0.43	2.54	2.58
DN20	3/4"	0.79	3.11	1.83	3.03	4.57	0.35	1.65	1.42	1.65	0.12	0.12	0.63	1/4-20UNC	1.10	0.94	0.83	1.08	0.53	2.99	3.11
DN25	1"	0.98	3.39	1.98	3.23	6.14	0.43	1.97	1.65	1.97	0.12	0.14	0.67	1/4-20UNC	1.38	1.24	1.05	1.36	0.53	3.39	3.39
DN32	1 1/4"	1.26	4.13	2.17	3.43	6.14	0.43	1.97	1.65	1.97	0.12	0.14	0.67	1/4-20UNC	1.69	1.54	1.38	1.70	0.55	4.13	4.13
DN40	1 1/2"	1.50	4.72	2.66	3.94	7.13	0.55	2.76	1.97	2.76	0.14	0.18	0.83	1/4-20UNC	1.97	1.77	1.59	1.94	0.59	4.72	4.72
DN50	2"	1.97	5.24	2.97	4.49	7.13	0.55	2.76	1.97	2.76	0.14	0.18	0.83	1/4-20UNC	2.40	2.20	2.07	2.41	0.69	5.28	5.28
DN65	2 1/2"	2.56	6.42	3.74	5.71	10.24	0.67	4.02	2.76	4.02	0.18	0.22	1.06	1/4-20UNC	2.95	2.72	2.56	3.03	0.73	6.42	6.42
DN80	3"	3.15	7.20	4.13	6.06	10.24	0.67	4.02	2.76	4.02	0.18	0.22	1.06	1/4-20UNC	3.74	3.35	3.15	3.54	0.79	7.24	7.24
DN100	4"	3.94	8.98	4.96	6.89	13.17	0.87	4.92	4.02	4.92	0.22	0.26	0.91	5/10-18UNC	4.72	4.13	3.98	4.53	0.98	8.98	8.98

UNIT: INCH